



Mac Chain Co. Ltd.

800-663-0072
[UNITED STATES]

800-663-0072
[WESTERN CANADA]

877-833-1653
[EASTERN CANADA]

MS110

ENGINEERED CLASS CHAIN > Steel Bushed Engineered Class Chain

Industry: AG Spreader, Grain Processing, Asphalt Paving, Car Wash Conveyor, Forest Products

Mac Engineering Class Chains are designed to withstand rigorous operating conditions across a range of applications.

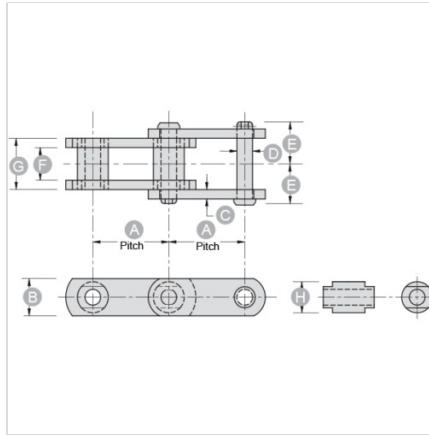

NOTE: All dimensions shown in inches unless noted otherwise.

Part Number	Average Pitch A	Ultimate Strength (lbs)	Sidebar Height B	Outer Sidebar Thickness	Inner Sidebar Thickness	Pin Diameter D
MS110	6.000	40,000	1 1/2	3/8	3/8	5/8

Part Number	Max. Overall Width E	Length of Bearing G	Max. Sprocket Thickness F	Links per Foot	Average Weight per Ft. (lbs)	Bushing diameter H
MS110	4 11/32	2 7/8	2	2.0	6.3	1 1/4

Questions about ordering? Call us!

WE'RE HERE TO HELP!

www.macchain.com
ussales@macchain.com

