



Mac Chain Co. Ltd.

800-663-0072
[UNITED STATES]

800-663-0072
[WESTERN CANADA]

877-833-1653
[EASTERN CANADA]

WR138PIN

WELDED STEEL PIN > Mill Chain H & C Type Pin

Industry: AG Spreader, Grain Processing, Asphalt Paving, Sanding Truck Conveyor, Car Wash Conveyor, Mobile Wood Waste Recycling, Forest Products

- Pins can be supplied "pre-drilled" for cotter pins
- Dimensions in brackets apply to optional 1" A~ Rivets
- Most rivets chamfered on end for "lead in"
- Custom sizes are also available

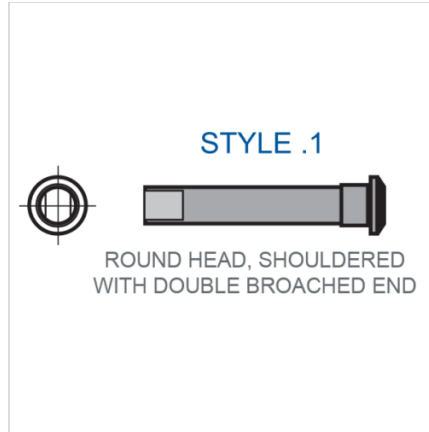
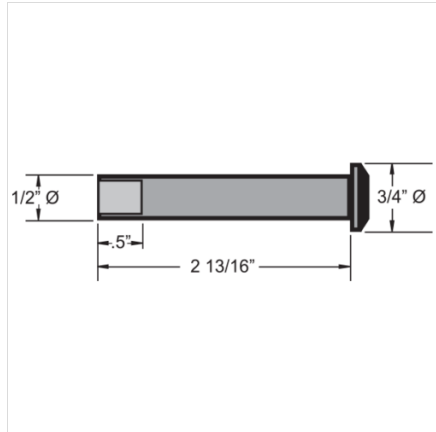

Part Number	Pin Style	Pin Size	Weight Per 100 pcs.
WR138PIN	1	1/2 x 2 13/16	15

Questions about ordering? Call us!

WE'RE HERE TO HELP!

www.macchain.com
ussales@macchain.com

